



12500kg 14 Pallet Footprint Unit Loadhouses Specification/Technical Data:

General Specification:

- This model of double deck lift is designed with the following considerations and requirements.
- To eliminate civil engineering works as associated with traditional scissor lifts.
 - To service double deck trailers with finished floor levels of 150mm up to 3000mm into a loading bay with heights from 900mm up to 1445mm.
 - Provision can also be made to run through from ground / yard-level on to lift.
 - To be modular in its build enabling rapid installation to reduce onsite disruption to clients.
 - The unit comprises of a base section and a lid to form the Loadhouse and lift.
 - To be easy to relocate from site to site and / or Bay to Bay.
 - Loadhouse Roof Designs may vary to suit Store/Location.

Operating range: 150mm to 3000mm - suitable for double deck trailers, rigid and articulated vehicles including European specification trailers.

Lifting Speed: 90 mm/s throughout the lift stroke.
Unlike scissor lifts, lift speed is linear throughout the whole cycle of the lift stroke giving consistent and quicker travel times.

Operation: Lift platform for lifting and lowering of goods and operators.

Capacity: 12500kg UDL

Load type configuration: Designed around 24 roll cages of 830 x 750mm x 500kg on plan. In conjunction with MHE the units can also accommodate 13 / 14 pallets of 1200 x 1000mm on plan.

Location: External, surface mounted onto goods yards, marrying up to the loading bay. No specialised pilings / foundations are required.

Overall Loadhouse dimensions: 4120mm (w) x 10000 (l) x 6860mm (h). Width subject to cladding variations. Height subject to roof specification.

Platform dimensions:
 Loading Area: 2890mm (w) x 7600mm (with a 650mm access area at the front of the lift to protect the front gates and access the platform controls).

Personnel access: 570mm (w) gantry to either the left hand or the right hand side of the lift. (Standard fit - Right hand side. When viewed from dock onto yard).

Lift Colours: External single skin cladding in grey - Goosewing Grey BS 10A05. Exterior framework, Interior Framework and Platform - Goose Grey BS 00A05. (Other colours available on request).



TRANSDEK UK Ltd.
 BRYANS CLOSE,
 HARWORTH, DONCASTER,
 SOUTH YORKSHIRE, DN11 8RY.
 TEL: 01302 752276
 WEB: www.transdek.com
 EMAIL: info@transdek.com

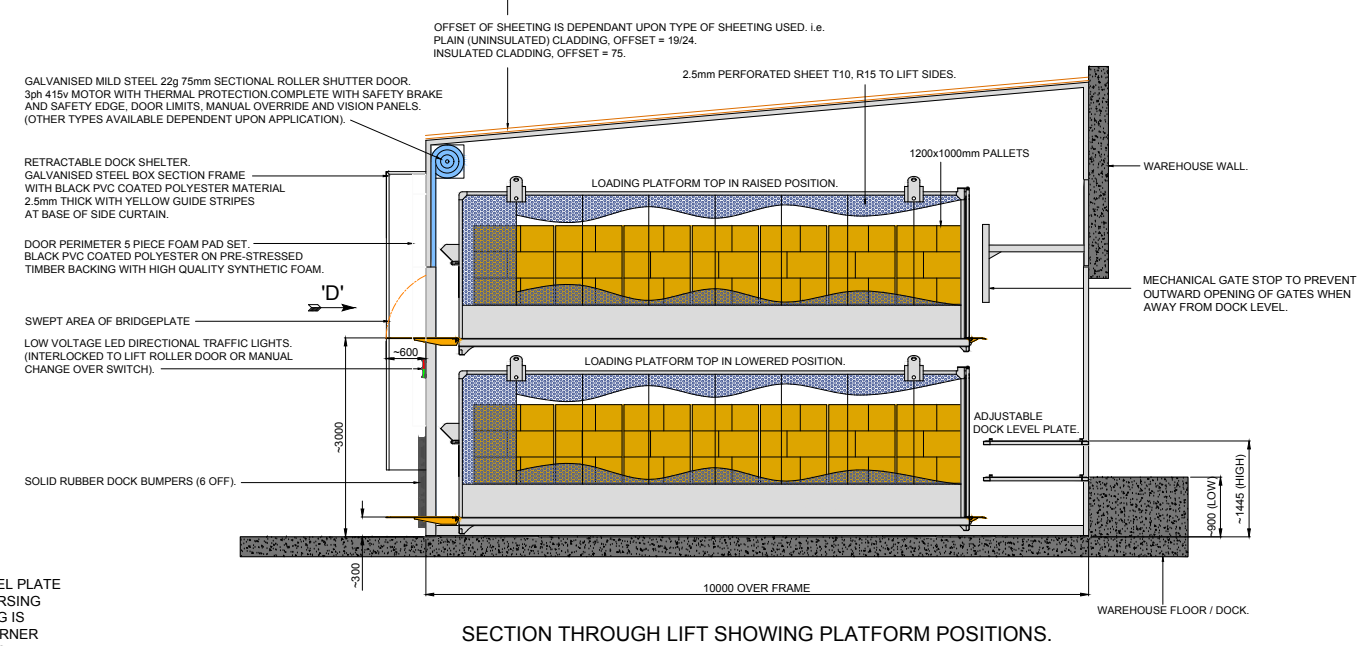
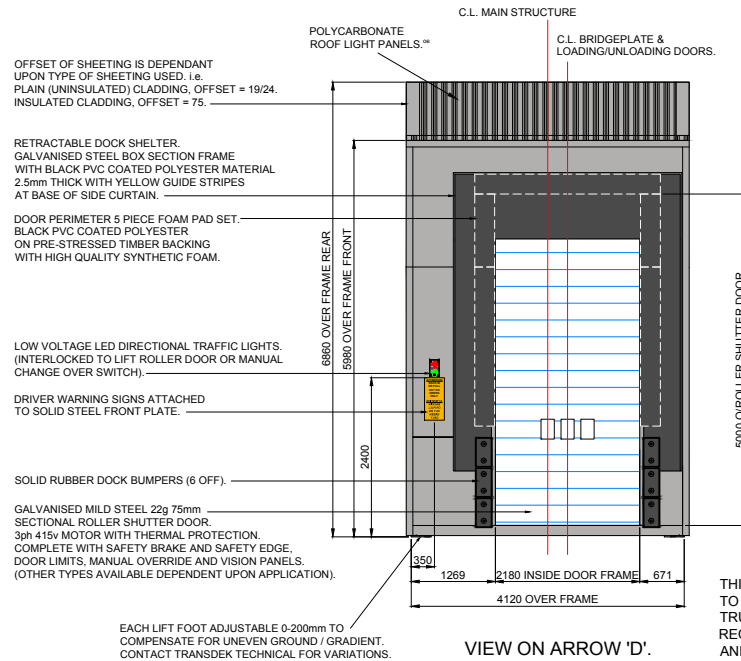
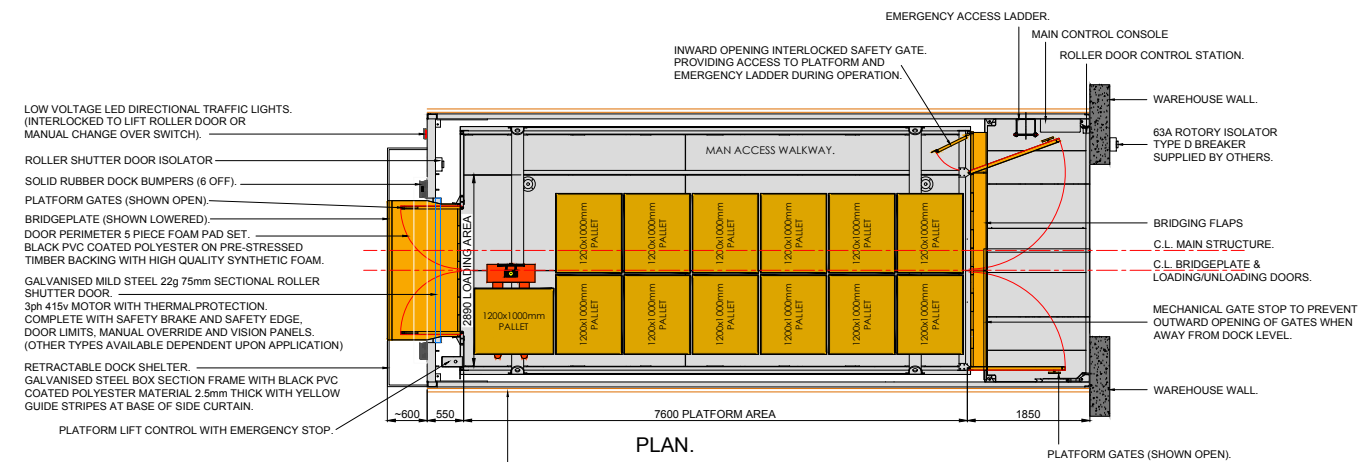

07					
06					
05					
04					
03					
02					
REV No.	REV CODE	REVISION NOTE	DATE	CHANGE BY	



THIS DRAWING IS THE PROPERTY OF TRANSDEK UK LTD AND IS CONFIDENTIAL. IT IS ISSUED SUBJECT TO THE CONDITIONS THAT:

- THE INFORMATION OR ANY PART THEREOF CONTAINED IN IT SHALL NOT BE DISCLOSED IN ANY FORM TO A THIRD PARTY.
- IT OR ANY PART OF IT SHALL NOT BE REPRODUCED IN ANY FORM.

GENERAL NOTES

- WELDING SYMBOLS STANDARD TO ISO 2553 METHOD B.
- REMOVE ALL BURRS AND SHARP EDGES.
- ALL DIMENSIONS IN MILLIMETRES UNLESS OTHERWISE STATED.
- THIRD ANGLE PROJECTION.

MATERIAL:	N/A	
FINISH:	N/A	
WELDING SPEC:	BS EN 1011-1:1998 & BS EN 1011-2:2001	DATE: 31/03/2017
TOLERANCES UNLESS OTHERWISE STATED		
MACHINING:	± 0.5	ANGULAR: ± 0.5°
FABRICATION & STRUCTURAL		
UP TO 300:	± 1	1001 UP TO 2000: ± 3
301 TO 1000:	± 2	OVER 2000: ± 5
SCALE:	NTS	
ESTIMATED WEIGHT:	N/A	
SHEET:	1 of 1	

PROJECT:	12500kg Double Deck Loadhouses	A1	BORDER VERSION: 4
TITLE:	12500kg Double Deck Loadhouses Specification/Technical Data		
DRG. No.	9200-011	REVISION:	01