

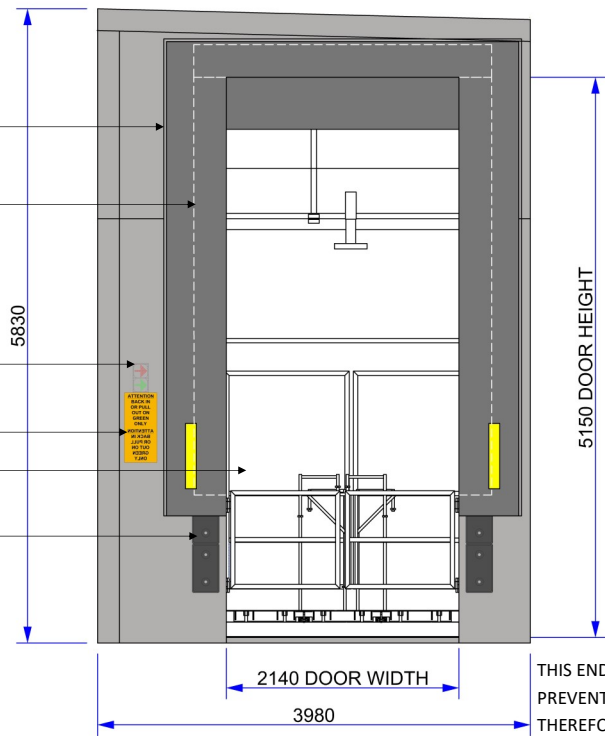

TRANSDEK UK LTD.
BRYANS CLOSE
HARWORTH, DONCASTER
SOUTH YORKSHIRE, DN11 8RY.
TEL: 01302 752276
WEB: www.transdek.com
EMAIL: info@transdek.com

- RETRACTABLE DOCK SHELTER. GALVANISED STEEL BOX SECTION FRAME WITH BLACK PVCCOATED POLYESTER MATERIAL 2.5mm THICK WITH YELLOW GUIDE STRIPES AT BASE OF SIDE CURTAIN.
- 5 PIECE FOAM PAD SET. BLACK PVC COATED POLYESTER ON PRE-STRESSED TIMBER BACKING WITH HIGH QUALITY SYNTHETIC FOAM.
- LOW VOLTAGE LED DIRECTIONAL TRAFFIC LIGHTS (INTERLOCKED TO WAREHOUSE ROLLER DOOR OR MANUAL CHANGE OVER SWITCH).
- DRIVER WARNING SIGNS
- PLATFORM GATES (SHOWN AS CLOSED)
- DOCK BUMPERS



FRONT ELEVATION

THIS END IS CLAD WITH SOLID STEEL PLATE TO PREVENT DAMAGE FROM REVERSING TRUCKS. THEREFORE NO SHEETING IS REQUIRED OTHER THAN 200mm CORNER AND FLOOR PERIMETER FLASHINGS

Double Deck Series: 6 Pallet Footprint Unit Specification/Technical Data

General Specification

This model of double deck lift is designed with the following considerations and requirements

- To eliminate civil engineering works as associated with traditional scissor lifts.
- To service double deck trailers with finished floor levels of 150mm up to 3125mm into loading bays, DCs, retail outlets and distribution centres.
- Provision can also be made to run through from warehouse onto yard.
- To be modular in its build enabling rapid installation to reduce onsite disruption. (The unit comprises of a base section and a lid to form the Loadhouse and lift).
- Loadhouse roof designs may vary to suit location such as store or DC canopies.
- Relocatable from site to site and/or bay to bay in a couple of days.

Operating Range: 150mm to 3125mm suitable for double deck trailers, rigid and articulated vehicles including European specification trailers (Provision can be made to run through from yard onto lift with the inclusion of a bridge plate ramp).

Lifting Speed: 90mm/s raising and lowering.
Unlike scissor lifts, lift speed is linear throughout the whole cycle of the lift stroke giving consistent and quicker travel times.

Operation: Lift platform for lifting and lowering of goods and operators.

Capacity: 6500kg UDL

Configuration: 5 pallets of 1200mm x 1000mm, weighing 1250kg (max).
In conjunction with MHE the units can also accommodate 12 wheeled roll cages of 860mm x 750mm, weighing 540kg (max) each plus operators—no passengers.

Location: External, Surface mounted onto goods yards, marrying up to the loading bay.
Internal, direct mounting onto warehouse slab.
No specialised pilings/foundations required.

Overall external dimensions: 3920mm (W) x 5000mm (L) x 5650mm (H).
Width subject to cladding variations. Height subject to roof specification.

Platform dimensions loading area: 2500mm (W) x 3500mm (L).
Plus a separate operator walkway from the rear to the front of the moving platform.

Personnel walkway: Provides constant segregated access for operators between vehicle and dock without the loss of any product space.

Lift colours: External single skin cladding in grey—Goosewing Grey BS 10A05.
Exterior framework/interior framework and platform—Goose Grey BS 00A05.
(other colours available on request).

CLADDING, OFFSET = 30mm.

LIFT CONTROL STATION.

PLATFORM GATES (SHOWN AS OPEN).

BRIDGEPLATE (SHOWN AS LOWERED).

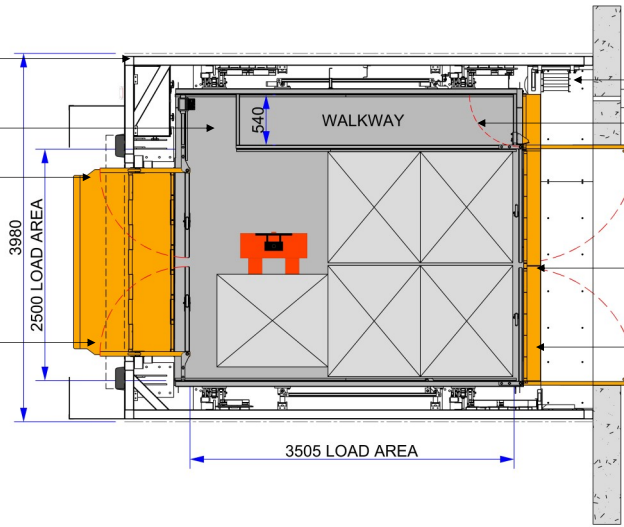

INCOMING MAINS SUPPLY. 415V 32A TYPE D MCB.

INWARD OPENING INTERLOCKED SAFETY GATE. PROVIDING ACCESS TO PLATFORM AND EMERGENCY LADDER DURING OPERATION.

MECHANICAL GATE STOP TO PREVENT OUTWARD OPENING OF GATES WHEN AWAY FROM DOCK LEVEL.

BRIDGING FLAPS.

PLATFORM GATES (SHOWN OPEN).

VEHICLE END

PLAN

WAREHOUSE END

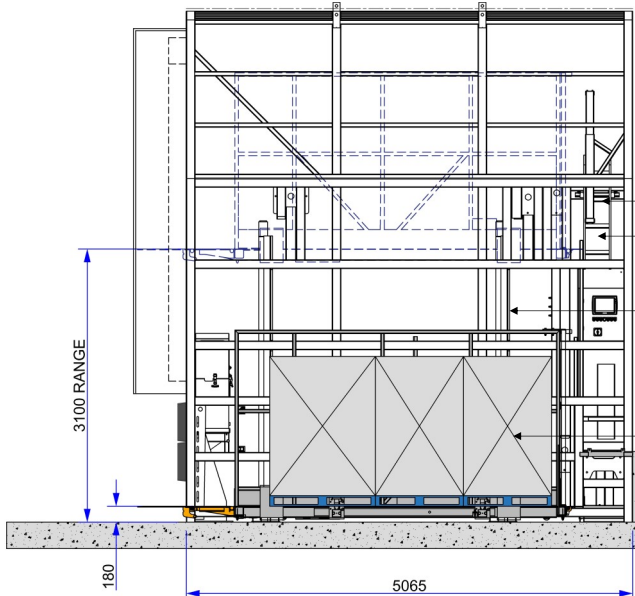

SECTION THROUGH LIFT SHOWING PLATFORM SERVICE RANGE

LID MODULE OPTIONAL DEPENDANT UPON SITE

EMERGENCY ACCESS LADDER

RAM BOX

PLATFORM SIDES FULLY CLAD TO PROTECT GOODS

1200mm x 1000mm PALLETS

RANGE 800mm TO 1500mm.

WAREHOUSE/YARD SLAB

07					
06					
05					
04					
03					
02					
REV No.	REV CODE	REVISION NOTE	DATE	CHANGE BY	



TRANSDEK UK LTD.
BRYANS CLOSE, HARWORTH,
DONCASTER, DN11 8RY
TEL: 01302 752276
FAX: 01302 752434
EMAIL: info@transdek.com

THIS DRAWING IS THE PROPERTY OF TRANSDEK UK LTD AND IS CONFIDENTIAL. IT IS ISSUED SUBJECT TO THE CONDITIONS THAT:

- THE INFORMATION OR ANY PART THEREOF CONTAINED IN IT SHALL NOT BE DISCLOSED IN ANY FORM TO A THIRD PARTY.
- IT OR ANY PART OF IT SHALL NOT BE REPRODUCED IN ANY FORM.

GENERAL NOTES

- WELDING SYMBOLS STANDARD TO ISO 2553 METHOD B.
- REMOVE ALL BURRS AND SHARP EDGES.
- ALL DIMENSIONS IN MILLIMETRES UNLESS OTHERWISE STATED.
- THIRD ANGLE PROJECTION.

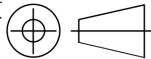

MATERIAL:
N/A

FINISH: N/A

WELDING SPEC: BS EN 1011-1:1998 & BS EN 1011-2:2001

TOLERANCES UNLESS OTHERWISE STATED

MACHINING: ± 0.5 ANGULAR: ± 0.5°

FABRICATION & STRUCTURAL

UP TO 300: ± 1 1001 UP TO 2000: ± 3

301 TO 1000: ± 2 OVER 2000: ± 5

DRAWN BY: AK

DATE: 03/06/2020

SCALE: N/A

ESTIMATED WEIGHT: N/A

SHEET: 1 of 1

PROJECT:
6 Pallet Double Deck Loadhouses

A3

BORDER
VERSION:
5

TITLE:
6 Pallet Double Deck Loadhouses
Specification/Technical Data

DRG. No.
6_Pallet_DD_6.5T_1

REVISION:
01